

ann AR111

instructions for use

1. Unscrew wall bracket off the glass-housing.
2. Unfasten module of the socket.
3. Conduct mains cable through cable entry point of the wall-bracket.
4. Attach wall bracket. Pay attention of position "top".
Use the washer gaskets with rubberized face showing to the wall bracket. At mounting holes which are not used arrange for density.
5. Hustle silicone-tubes over the power lines.
6. Establish protective conductor connection and conduct electrical junction.
7. Remount module of the socket.
8. Insert light bulb and connect it.
9. Hustle glass-housing onto the wall-bracket and assure it with countersunk head screws..

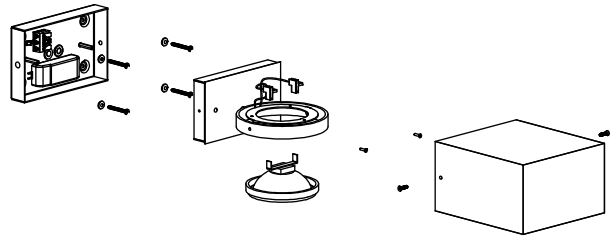

light technology:

low-voltage halogen lamp
QR111
50W/G53

 EEC

technical information:

operating voltage 230V / 50Hz

 protection class

 safety class 1

 Luminaire is suitable for mounting on normal inflammable fixing surfaces.

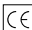
 conformity mark

relamping and maintenance:

Disconnect the electrical installation.

Change lamp. Check the gaskets and if necessary clean or replace it.

care:

Regularly clean luminaire from dirt and deposits. Do not use a high pressure cleaner for cleaning.

Please note care instructions at www.IP44.de.

See service documents:

Care of stainless steel rustless.

safety:

We point out that the electric connection of light fixtures has to be done by a certified installer.

We assume no accountability for damages which are a result of non-appropriate mounting or application of the luminaire.

Modifications on the luminaire will result in loss of warranty.

Attention: Please note that some parts of this luminaire can produce temperatures higher than 90°C when it is in operation. To prevent burns, please avoid any contact!

Please keep the instructions with the service documents!